

RHP600型
功率型厚膜电阻器
HIGH POWER THICK FILM RESISTORS
 SERIES RHP600

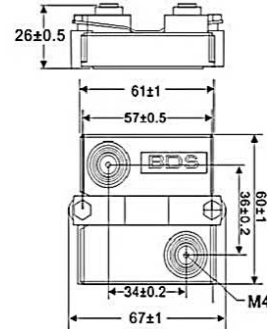

■ 构造图 Construction



■ 特点 Characteristics

- 无感设计,阻值范围宽
- 大功率(底板中心温度 $\leq 85^{\circ}\text{C}$ 时功率为600W)
- 耐高压6KV
- 引出端安装M⁴螺钉最大扭矩: 2Nm
- 散热片安装M⁴螺钉最大扭矩: 2Nm
- 电感 $< 80\text{nH}$

- Non-inductive, wide resistance range
- High power (the temp of floor center less than 85°C , the power is 300W)
- High voltage withstanding 6KV
- Contact terminal :M⁴ screw, Max.torque 2Nm
- Resistor inatallation :M⁴ screw, Max.torque 2Nm
- Inductance $< 80\text{nH}$

■ 技术标准 Technical Standard

GB/T5729-2003 电子设备用固定电阻器
 第一部分: 总规范
 Q/BDS 018-2017 RHP型功率厚膜固定电
 阻器详细规范

■ 应用领域 Application Area

电气传动,变频调速,光伏逆变,无功补偿,电容
 均压,阻容吸收,风力/光伏发电等新能源领域。

■ 降功耗曲线 Derating Curve

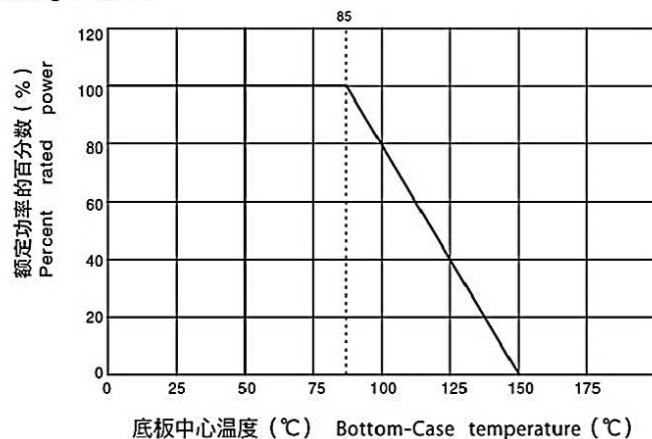

RHP600型
功率型厚膜电阻器
HIGH POWER THICK FILM RESISTORS
 SERIES RHP600



■ 主要技术参数 Performance Characteristics

型号Model	85℃额定功率 Power Rating at 85℃	阻值范围 Resistance Range(Ω)	电阻温度系数 TCR (ppm/℃)	阻值精度 Resistance Tolerance(%)	最大工作电压 Max.work Voltage(V)	工作温度 Work Temperature
RHP600	600W	$R \leq 1\Omega$	± 500	$\pm 10\%$	5KV	$-55^{\circ}\text{C} \sim +155^{\circ}\text{C}$
		$1\Omega < R \leq 10\Omega$	± 300	$\pm 5\%$		
		$R > 10\Omega$	± 150	$\pm 5\%$		

- 所示功率需加散热器
- The condition of the above power is needed to mount a heatsink.
- 更高参数可协商供货
- Special specifications can be supplied in consultation with customers.

■ 特性参数 –通用 Technical Data _General

试验项目 TEST ITEM	性能要求 SPECIFICATIONS	试验方法TEST METHOD GB/T5729-2003 IEC60115-1: 2001
短时间过载 Short time overload	1.5倍额定功率,10秒 1.5 times rated power 10s $\Delta R \leq \pm (0.5\%R + 0.05\Omega)$	4.13
快速温度变化 Rapid temperature change	$\Delta R \leq \pm (0.5\%R + 0.05\Omega)$	4.19
气候顺序 Temperature cycling	$\Delta R \leq \pm (1\%R + 0.05\Omega)$	4.23
稳态湿热 Humidity (steady States)	$\Delta R \leq \pm (0.5\%R + 0.05\Omega)$	4.24
寿命 Load life	$\Delta R \leq \pm (1\%R + 0.05\Omega)$	4.25.2